

# Swiss Viva Grand



⊗ Power wheelchair Swiss Viva Grand

Length with/without legrests 98/73 cm

Width 63 cm

Loading capacity 180 kg

Speed 10 km/h

005.40.4000

€  
**8'750.00**

☐ Quotation request

☐ Order

Company:

Street:

Place, post code:

Phone:

Customer ref.:

E-mail:

Delivery address:

☐ same as above

Company:

Date:

Street:

Place, post code:

Signature :

## Base configuration

- Seating position and center of gravity adjustable
- Comfort armrests
- Built-in charger
- LED lighting
- Transportation fixtures
- Completely swivel back legrests
- Batteries 2x63 Ah (C5)
- High quality four-pole motors
- Individual wheel suspension (adjustable)

☐ Standard

☐ Option

## Voluntary customer data\*

Height:  
Weight:

Indication :  
Health insurance:

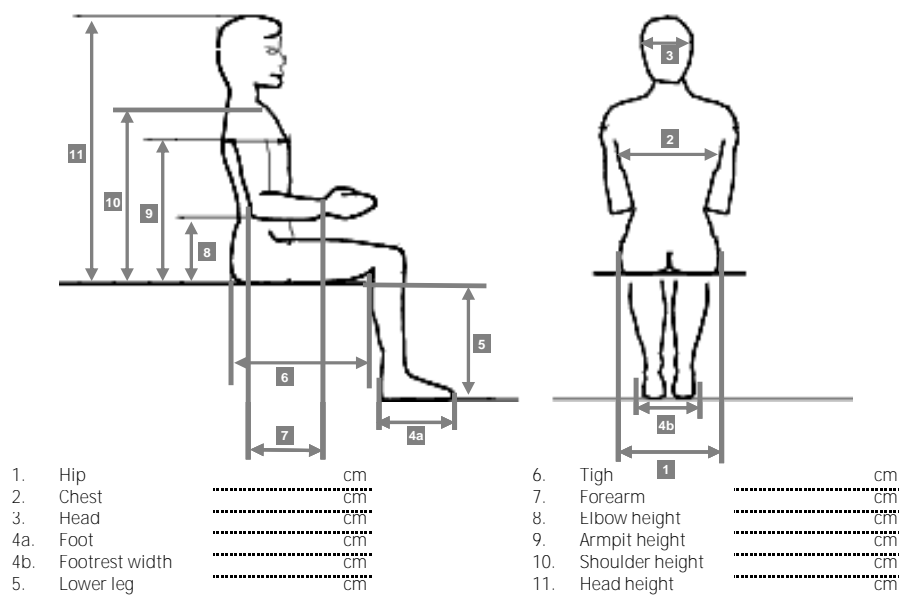

Price ex. VAT

€

## 1 Base configuration

### Seat width (measure 1)

- ☐ 36 to 53 cm (continuously adjustable)  
☐ other: \_\_\_\_\_

adjusted to: \_\_\_\_\_

auf Anfrage  
upon request

### Seat depth (measure 6)

- ☐ 40 bis 54 cm (countiously adjustable)  
☐ Special: \_\_\_\_\_

adjusted to: \_\_\_\_\_

upon request

### Seat frame height (without cushion)

- ☐ 42.5 cm ☐ 46.5cm ☐ 50.5 cm

(Using standard SKS seat cushion, seat height = seat frame height plus 4 cm)

### Colour set, fabric

- ☐ black matt finished  
☐ traffic yellow, matt finished  
☐ emerald green, matt finished  
☐ frame in special colour: \_\_\_\_\_

- ☐ white matt finished  
☐ ultramarine blue, matt finished  
☐ traffic red, matt finished

25.3051	90.00
25.3051	90.00
25.3051	290.00

- ☐ Spacer fabric 3D black, air circulating  
☐ real leather  
☐ Armrests only

- ☐ leatherette black

25.3055	220.00
---------	--------

## 2 Seating

### Powered seat functions

<input type="checkbox"/> Tilt-in-space (50°/40° with seatlift)	005.20.0306	<b>1'650.00</b>
<input type="checkbox"/> Heavy Duty Package (recommended above 120kg)	25.3061	<b>5'800.00</b>
<input type="checkbox"/> Seatlift (0-30 cm)	005.20.0304	<b>2'200.00</b>
<input type="checkbox"/> Seat cushion powered to be advanced(<100mm)	22.0399/22.0379	<b>2'650.00</b>

### Seat cushioning

<input type="radio"/> Anatomic cushioning		
<input type="checkbox"/> Comfort: incl. Tightening belts and extra latex cushioning	20.0035	895.00
<input type="checkbox"/> Board only (for use of anti-decubitus cushions)		
<input type="checkbox"/> Cushion: <input type="checkbox"/> VARILITE® Meridian <input type="checkbox"/> other .....		
<input type="checkbox"/> VARILITE® Zoid		
<input type="checkbox"/> Recaro (specify page 7)		
<input type="checkbox"/> Upholstery filling sealed	verhauthen	165.00
<input type="checkbox"/> Removable seat cover	25.3066	180.00
<input type="checkbox"/> w/o seat board (fixtures are delivered)		

## 3 Backrest

### Powered backrest functions

<input type="checkbox"/> Biodynamic positioning package	005.20.0410	<b>2'850.00</b>
• Backrest recline up to 153°	005.20.0403	
• Length compensation	005.20.0404	
• Anatomic curved shell for trunk support ( 3D-spacer), tunable in width	001.20.0433	
• Reclining armrests (together with backrest), flip back to ease transfer	005.20.0320	
• Armpads retractable		
<input type="checkbox"/> Backrest recline up to 153°	005.20.0403	<b>1'290.00</b>
<input type="checkbox"/> Length compensation	005.20.0404	<b>1'250.00</b>
<input type="checkbox"/> Backrest mounted (6 cm lower) , backrest recline restricted	005.20.0405	150.00

### Backrest cushioning

<input type="radio"/> Standard back with slight contour (height 40 cm)		
<input type="checkbox"/> Anatomic curved shell for trunk support ( 3D-spacer), tunable in width	001.20.0433	960.00
<input type="checkbox"/> w/o lumbar support <input type="checkbox"/> with lumbar support		
Backshell height		
<input type="checkbox"/> 40 cm <input type="checkbox"/> 48 cm		
<input type="checkbox"/> longer trunk support wings (std 10 cm) <input type="checkbox"/> 15 cm <input type="checkbox"/> 18 cm <input type="checkbox"/> 22 cm	005.20.0431	320.00
<input type="checkbox"/> Thermal bridge	005.20.0406	80.00
<input type="checkbox"/> VARILITE® ICON™	70.1129	<b>1'105.00</b>
<input type="checkbox"/> w/o backrest (incl. holders for 3rd party backrest)		
<input type="checkbox"/> Back rest foldable (not in comb. with length compensation)	22.0265	550.00

## 4 Armrests

### Armrest height from seat frame (14 to 40 cm)

<input type="radio"/> Standard pluggable		
<input type="checkbox"/> Reclining armrests (together with backrest), flip back to ease transfer	005.20.0320	950.00
<input type="checkbox"/> Armpads retractable	005.20.0303	655.00
<input type="checkbox"/> Elbow shells		
<input type="checkbox"/> Armpad concave	005.20.0023	62.00
<input type="checkbox"/> left <input type="checkbox"/> right		
<input type="checkbox"/> Armpad with side support	005.20.0024	85.00
<input type="checkbox"/> left <input type="checkbox"/> right		
<input type="checkbox"/> Hemiplegic shell	30.8002	upon request
<input type="checkbox"/> left <input type="checkbox"/> right		
<input type="checkbox"/> with pivot joint for individual arm positioning		
<input type="checkbox"/> Arm or thigh support according to separate sketch		upon request

## 5 Legrests

### Legrest type

<input type="radio"/> 180° swing away and removable (foot plate and legrest carrier angle adjustable)		
<input type="checkbox"/> additional pair of standard leg rests in conjunction with initial order	005.20.0504	300.00
<input type="checkbox"/> Knee pads (height and depth adjustable)	25.3056	580.00
<input type="checkbox"/> Power elevating      Pad distance <input type="radio"/> short <input type="checkbox"/> long	005.20.0503	<b>1'950.00</b>
<input type="checkbox"/> Power elevating foot plates	22.0242	<b>2'950.00</b>
<input type="checkbox"/> Swing away activation with extended lever	005.20.0550	140.00
<input type="checkbox"/> Legrest elastically supported <input type="checkbox"/> hard <input type="checkbox"/> medium	22.0234	520.00
<input type="checkbox"/> Central legrest manually elevating	005.22.0112	927.00
<input type="checkbox"/> Central legrest power elevation and length compensating	004.22.0108	<b>2'950.00</b>
<input type="checkbox"/> Limiting switch on footplate to prevent floor collision	22.0172-3	385.00
<input type="checkbox"/> Power elevating foot plate	22.0242	<b>2'950.00</b>
Lower leg length (watch seat height)	004.22.0172	<b>1'475.00</b>
<input type="checkbox"/> Lower leg length 36 bis 58 cm      adjusted to ..... cm		
<input type="checkbox"/> Other lower leg length: ..... cm	001.20.0505	73.00

### Footplate (aluminium, angle adjustable on 2 axes)

<input type="checkbox"/> 1 cm upholstery	25.3031	95.00
<input type="checkbox"/> Single end-to-end footplate foldable to the:	005.20.0602	158.00
<input type="checkbox"/> left <input type="checkbox"/> right		

## 6 Wheels, tires and frontcaster lock

- ☒ black non-marking

### Rear wheels (block profile)

<input type="radio"/> Air (with tube sealant)		
<input type="checkbox"/> Full (polyurethane)	20.0620	35.00
<input type="checkbox"/> Outdoor (air, w/o mudguards)	20.0621	452.00

### Front wheels

<input type="radio"/> Full (polyurethane)	<input type="checkbox"/> Air (with tube sealant)
<input type="checkbox"/> Small 230 x 60	

### Front caster lock

<input type="checkbox"/> Electromagnetic front caster lock	005.20.0305	<b>1'150.00</b>
<input type="checkbox"/> Operated via extra switch (not via control panel)		
<input type="checkbox"/> on control panel side		
<input type="checkbox"/> opposite control panel	<input type="checkbox"/> opposite underneath armpad	
<input type="checkbox"/> Switch placed according to special sketch		upon request

## 7 Control equipment

### Remote control

- ☐ R-Net Standard CJS1 flat with LCD-Display
- ☐ R-Net Advanced CJS2 (large LCD-Display includes Bluetooth) 30.3207 980.00
- ☐ Heavy Duty model (CJS1 or 2) M002-24/M002-44 980.00
- ☐ R-Net OMNI II colour display incl. infrared capabilities, bluetooth and USB charging 30.3245 **2'450.00**
- ☐ other: \_\_\_\_\_ auf Anfrage
- ☐ Activate theft prevention function

### Joystick module mounting

- ☐ left ☐ right
- ☐ Standard (pluggable, length adjustable)
- ☐ Swivel back and down 005.20.0910 320.00
- ☐ Swivel back and down with rear stopper 005.20.0910 Anschlag 420.00
- ☐ Endposition inside (shorter upper leg upholstery) 005.20.0910 Endposition
- ☐ Electrically swivelling unit (sep. measures required) 25.3058 upon request
- ☐ other: \_\_\_\_\_ upon request
- ☐ Joystick module alternatively mountable on the back for attendand 25.3046 185.00

### Joystick shape

- ☐ Cylinder (standard)
- ☐ Ball, diameter 30 mm 004.20.0950 29.00
- ☐ Ball, diameter 40 mm 004.20.0951 29.00
- ☐ Golfball 001.20.0952 45.00
- ☐ Tetraplegia ball 22.6002 95.00
- ☐ Joystick shape according to sketch upon request

### External switching for on/off and mode (up to 3 switches)

- ☐ Twister (x 17 mm) 001.22.0062 480.00
- Please, sketch position

### External switches for direct control of actuators

- ☐ Switch module ☐ Push buttons (6 channels) 30.3241/42 890.00
- ☐ left ☐ right ☐ Toggle switches (5 channels) 30.3231 980.00

### Special control

- ☐ Table with turnable joy stick module in the middle 22.0915 **2'950.00**  
table swivelling to the ☐ left ☐ right  
Distance between back and belly: \_\_\_\_\_
- ☐ Version power turnable, swivelling to the left 001.20.0918 **5'850.00**
- ☐ Special Joysticks
  - ☐ SKS SJ 650 HD (Force 650g, sockets for 2 switches) P002-73/77 **1'945.00**
  - ☐ SKS SJ 250 (Force 250g, sockets for 2 switches) P002-71/75 890.00
  - ☐ SKS SJ 120 (Force 120g, sockets for 2 switches) P002-72/76 **1'790.00**
  - ☐ SKS SJ 50 (Force 50g, sockets for 2 switches) P002-6x **1'980.00**
  - ☐ SKS SJ 10 (Force 10g, no sockets) P002-5x **2'180.00**
- ☐ Chin control unit 001.20.0905 **3'130.00**
- ☐ Head control with proximity sensors 001.20.0929 **4'200.00**
- ☐ Puff and sip device 001.20.0906 upon request
- ☐ Foot-control 001.20.0901 **2'105.00**
- ☐ Bluetooth 001.20.0926
- ☐ PC, Android ☐ i-Devices 980.00
- ☐ Dual port USB-Charger, 3 Amps P010-61/62 330.00
- ☐ Generic Mobile holder 35.3059 250.00
- ☐ Attendant control 001.20.0913 960.00
- ☐ Attendant control, Scootcontrol (handlebar) 001.20.0932 2069.00
- Mounting bracket swing-out for Scootcontrol 001.20.0937 480.04
- ☐ Remote emergency stop 20.0101 940.00
- ☐ System with gyro 30.3209 **1'290.00**
- ☐ Smartglass-Control "Munevo Drive" 25.3080 6'872.00
- Mounting, configuration and commissioning 25.3080inbetrieb ~ 690.00

## 8 Transportation fixture and Charging

### Transport

<input type="checkbox"/> Powered lowerable bolt for EZ-Lock/Q-Straint system	005.20.0400	<b>1'250.00</b>
<input type="checkbox"/> Dahl docking fitting set incl. wheelchair adaptation	20.0405	1005.00
<input type="checkbox"/> Dahl Docking Station MK II	20.0404	2340.00

### Charger

<input type="radio"/> Built-in (8 A)		
<input type="checkbox"/> External power charger (10A) for heavy user	001.20.0703	165.00

## 9 Accessories

<input type="checkbox"/> Headrest small 90 mm, multi-adjustable	005.25.3020	545.00
<input type="checkbox"/> with quick release handles for easy adjustment	005.25.3020 kl	680.00
<input type="checkbox"/> Headrest large 130 mm, multi-adjustable	005.25.3021	545.00
<input type="checkbox"/> with quick release handles for easy adjustment	005.25.3021 kl	680.00
<input type="checkbox"/> Abduction block, mounted with special fixture	005.20.1206	185.00
<input type="checkbox"/> Heel loops	25.3011	60.00
<input type="checkbox"/> Instep bands with quick-release buckles and upholstery	30.4835	85.00
<input type="checkbox"/> Heel shells with instep band	25.3013	115.00
<input type="checkbox"/> Calf strap (5cm) incl. fixture, with velcro closure	003.20.1211	88.00
<input type="checkbox"/> Seatbelt with easy snap buckle:	25.3081	145.00
<input type="checkbox"/> Glass table transparent, 600 x 450 mm (width x depth) to be swivelled out to the left or right; swivels out opposite to the control panel side	001.20.1218	upon request

Distance between back and belly: .....

Indicate distance x!

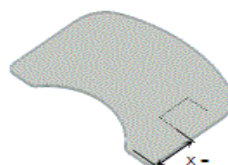

<input type="checkbox"/> Backbag SKS		65.3061	79.00
<input type="checkbox"/> Bag below armrest SKS		65.3062	69.00
<input type="checkbox"/> Transfer handles, indicate position	<input type="checkbox"/> left	25.3057	upon request
<input type="checkbox"/> Medical device platform, indicate measures	quantity: .....	25.3065	650.00
<input type="checkbox"/> Rearview mirror mounted on special swivel-down un	<input type="checkbox"/> left	001.20.1216/25.3004	265.00
<input type="checkbox"/> Cane fixture (for 2 canes), mounted on the rear	<input type="checkbox"/> right	001.20.1209	145.00
<input type="checkbox"/> Snap-hook system for respirator system		005.20.1207	225.00

## 10 Shipment and delivery

<input checked="" type="checkbox"/> Shipment, packaging und customs	Transk	
<input checked="" type="checkbox"/> Be aware of the fact that the VAT is to be added, yet incurred seperately by the customs authority.	MwSt Export	
<input type="checkbox"/> Delivery support by SKS-employee	25.3054	495.00
	25.3054kl	450.00
<input checked="" type="checkbox"/> Prices are ex VAT and ex. works		

Price ex. VAT

€

## 11 Popular 3rd-party seating systems

<input type="checkbox"/> Recaro	22.0300	
<input type="checkbox"/> Specialist M		<b>1'500.00</b>
<input type="checkbox"/> Expert M		<b>1'650.00</b>
<input type="checkbox"/> Orthopäd		<b>3'800.00</b>
<input type="checkbox"/> andere _____		upon request
<input type="checkbox"/> König		
<input type="checkbox"/> K 310-short superflat-Reha ErgoBase	20-K310-K-MOB	<b>3'650.00</b>

## Sketch positions, details and specials