

Swiss Viva Junior S



⊗ Power wheelchair **Swiss** Viva Junior S
Length with legrests 107 cm
Width 59 cm

005.40.4011

€
27'650.00

☐ Quotation request

☐ Order

Company:

Street:

Place, post code:

Phone:

Customer ref.:

E-mail:

Delivery address:

☐ same as above

Company:

Date:

Street:

Place, post code:

Signature :

Base configuration

- Individual wheel suspension (adjustable)
- Charger
- LED lighting
- Transportation fixtures
- Batteries (2x 63 Ah, C20)
- Seatlift (0-30 cm)
- Comfort armrests reclining with backrest and flip back
- Dynamic kneepads multi-adjustable
- Powered backrest recline, length compensating
- Powered verticalisation
- Powered tilt-in space
- Powered central legrest

☐ Standard

☐ Option

Voluntary customer data*

Height:
Weight:

Indication :
Health insurance:

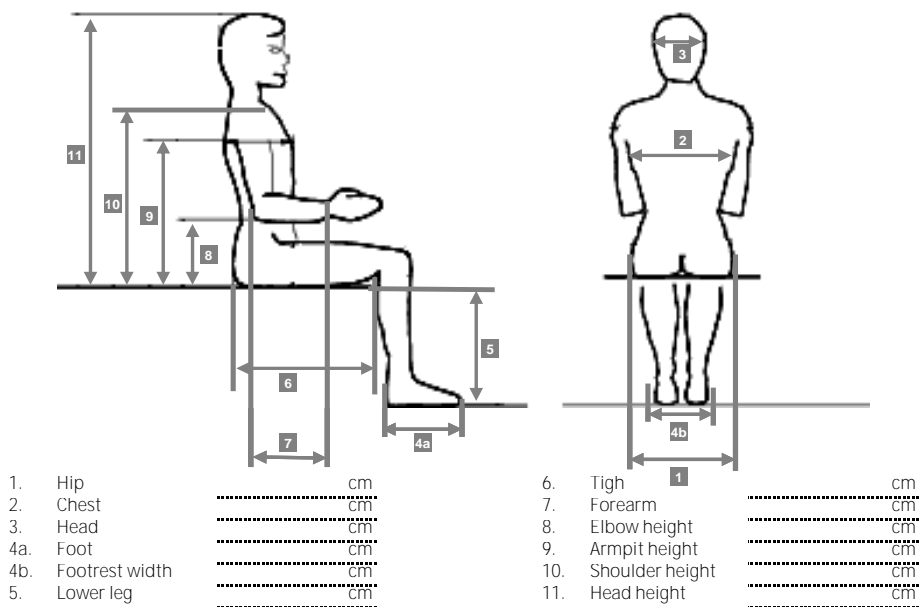

Preise ex. Mwst

€

1 Base configuration

Seat width (measure 1)

☐ 27 to 38 cm (continuously adjustable)

adjusted to:

Seat depth (measure 6)

☐ 30 cm ☐ 32.5 cm ☐ 35 cm ☐ 37.5 cm ☐ 40 cm

Seat frame height (without cushion)

☐ 47.5 cm

(Using standard SKS seat cushion, seat height = seat frame height plus 4 cm)

Colour set, fabric

Colour set

| | | | | |
|--|----------|--------------------------------------|----------|-------------------|
| <input type="checkbox"/> Turquoise blue | RAL 5018 | <input type="checkbox"/> Marine blue | RAL 5002 | |
| <input type="checkbox"/> Raspberry red | RAL 3027 | | | |
| <input type="checkbox"/> Nightrider (Glow in the dark) | | | | 25.3051 290.00 |
| <input type="checkbox"/> frame in special colour: | _____ | | | 25.3051 290.00 |
| <input type="checkbox"/> wheel rim in special colour: | _____ | | | 25.3052 140.00 |

2 Seating

Seat cushioning

- ☐ Anatomic cushioning
 - ☐ Comfort: incl. Tightening belts and extra latex cushioning 20.0035 895.00
- ☐ Board only (for use of anti-decubitus cushions)
 - ☐ Cushion: ☐ VARILITE® Meridian ☐ other
 - ☐ VARILITE® Zoid
- ☐ Upholstery filling sealed verhauten 165.00
- ☐ Removable seat cover 25.3066 180.00
- ☐ w/o seat board (fixtures are delivered)

3 Backrest

Upper body restraint

- ☐ Upper body H-belt
- ☐ Cross bar
- ☐ Upper body belt with snap-buckle
- ☐ Table transparent, 600 x 450 mm (width x depth) to be swivelled out P010-61/62 330.00
- ☐ Plug-in mini-table 001.20.0913 960.00

Backrest cushioning

- ☐ Standard back with slight contour (height 40 cm)
- ☐ Anatomic curved shell for trunk support (3D-spacer), tunable in width 001.20.0433 960.00
 - ☐ w/o lumbar support ☐ with lumbar support
- Backshell height
 - ☐ 30 cm ☐ 35 cm
 - ☐ longer trunk support wings (std 8 cm) ☐ 13 cm ☐ 16 cm 005.20.0432 321.00
- ☐ Thermal bridge 005.20.0406 80.00
- ☐ VARILITE® ICON™ 70.1129 **1'105.00**
- ☐ w/o backrest (incl. holders for 3rd party backrest)
- ☐ Back rest foldable (not in comb. with length compensation) 22.0265 550.00

4 Armrests

Armrest height from seat frame

- ☐ Elbow shells
- ☐ Armpad concave 005.20.0023 62.00
 - ☐ left ☐ right
- ☐ Armpad with side support 005.20.0024 85.00
 - ☐ left ☐ right
- ☐ Arm or thigh support according to separate sketch auf Anfrage

5 Legrests

Legrest type

- ☐ Dynamic kneepads plug-in ☐ shells 3 cm longer ☐ onesided ☐ bothsided
☐ Lower leg length 28-40 cm **adjusted to cm**

Footplate (aluminium, angle adjustable on 2 axes)

- | | | |
|--|-----------------|-----------------|
| <input type="checkbox"/> Footrests, one per foot individually foldable | 005.20.0309-Duo | 590.00 |
| <input type="checkbox"/> standard (270 mm) <input type="checkbox"/> large (363) | | |
| <input type="checkbox"/> "Furniture protection buffer" | 253089 | 95.00 |
| <input type="checkbox"/> Limiting switch on footplate to prevent floor collision | 22.0172-3 | 385.00 |
| <input type="checkbox"/> Power elevating foot plate | 22.0242 | 2'950.00 |

6 Wheels, tires and frontcaster lock

- ☒ black non-marking

Rear wheels (block profile)

- | | | |
|---|---------|-------|
| <input type="radio"/> Air (with tube sealant) | | |
| <input type="checkbox"/> Full (polyurethane) | 20.0620 | 35.00 |

Front wheels

- | | | |
|---|--|--------|
| <input type="radio"/> Full (polyurethane) | <input type="checkbox"/> Air (with tube sealant) | |
| <input type="checkbox"/> High-end foamed PU-tyres for difficult terrain and obstacles | 30.4315 | 290.00 |

Front caster lock

- | | | |
|--|---|-----------------|
| <input type="checkbox"/> Electromagnetic front caster lock | 005.20.0463 | 1'150.00 |
| <input type="checkbox"/> backwheel casters additionally | 005.20.0463 hi | 750.00 |
| <input type="checkbox"/> Operated via extra switch (not via control panel) | | |
| <input type="checkbox"/> on control panel side | | |
| <input type="checkbox"/> opposite control panel | <input type="checkbox"/> opposite underneath armpad | |
| <input type="checkbox"/> Switch placed according to special sketch | | auf Anfrage |

7 Control equipment**Remote control**

- ☐ R-Net Standard CJSM1 flat with LCD-Display
- ☐ R-Net Advanced CJSM2 (large LCD-Display includes Bluetooth) 30.3207 980.00
- ☐ Heavy Duty model (CJSM1 or 2) M002-24/M002-44 980.00
- ☐ R-Net OMNI II colour display incl. infrared capabilities, bluetooth and USB charging 30.3245 **2'450.00**
- ☐ other: _____ auf Anfrage
- ☐ Activate theft prevention function

Joystick module mounting

- ☐ left ☐ right
- ☐ Standard (pluggable, length adjustable)
- ☐ Swivel back and down 005.20.0910 320.00
- ☐ Swivel back and down with rear stopper 005.20.0910 Anschlag 420.00
- ☐ Endposition inside (shorter upper leg upholstery) 005.20.0910 Endposition
- ☐ Electrically swivelling unit (sep. measures required) 25.3058 auf Anfrage
- ☐ other: _____ auf Anfrage
- ☐ Joystick module alternatively mountable on the back for attendand 25.3046 185.00

Joystick shape

- ☐ Cylinder (standard)
- ☐ Ball, diameter 30 mm 004.20.0950 29.00
- ☐ Ball, diameter 40 mm 004.20.0951 29.00
- ☐ Golfball 001.20.0952 45.00
- ☐ Tetraplegia bail 22.6002 95.00
- ☐ Joystick shape according to sketch auf Anfrage

External switching for on/off and mode (up to 3 switches)

- ☐ Twister (x 17 mm) 001.22.0062 480.00
- Please, sketch position

External switches for direct control of actuators

- ☐ Switch module ☐ Push buttons (6 channels) 30.3241/42 890.00
- ☐ left ☐ right ☐ Toggle switches (5 channels) 30.3231 980.00

Special control

- ☐ Table with turnable joy stick module in the middle 22.0915 **2'950.00**
table swivelling to the ☐ left ☐ right
Distance between back and belly: _____
- ☐ Version power turnable, swivelling to the left 001.20.0918 **5'850.00**
- ☐ Special Joysticks
 - ☐ SKS SJ 650 HD (Force 650g, sockets for 2 switches) P002-73/77 **1'945.00**
 - ☐ SKS SJ 250 (Force 250g, sockets for 2 switches) P002-71/75 890.00
 - ☐ SKS SJ 120 (Force 120g, sockets for 2 switches) P002-72/76 **1'790.00**
 - ☐ SKS SJ 50 (Force 50g, sockets for 2 switches) P002-6x **1'980.00**
 - ☐ SKS SJ 10 (Force 10g, no sockets) P002-5x **2'180.00**
- ☐ Chin control unit 001.20.0905 **3'130.00**
- ☐ Head control with proximity sensors 001.20.0929 **4'200.00**
- ☐ Puff and sip device 001.20.0906 auf Anfrage
- ☐ Foot-control 001.20.0901 **2'105.00**
- ☐ Bluetooth 001.20.0926
 - ☐ PC, Android ☐ i-Devices 980.00
- ☐ Dual port USB-Charger, 3 Amps P010-61/62 330.00
- ☐ Generic Mobile holder 35.3059 250.00
- ☐ Attendant control 001.20.0913 960.00
- ☐ Attendant control, Scootcontrol (handlebar) 001.20.0932 2069.00
- Mounting bracket swing-out for Scootcontrol 001.20.0937 480.04
- ☐ Remote emergency stop 20.0101 940.00
- ☐ System with gyro 30.3209 **1'290.00**
- ☐ Smartglass-Control "Munevo Drive" 25.3080 6'872.00
- Mounting, configuration and commissioning 25.3080inbetrieb 690.00

8 Transportation fixture and Charging

Transport

| | | |
|---|---------|---------|
| <input type="checkbox"/> Dahl docking fitting set incl. wheelchair adaptation | 20.0405 | 1005.00 |
| <input type="checkbox"/> Dahl Docking Station MK II | 20.0404 | 2340.00 |

Charger

- ☒ External charging device

9 Accessories

| | | |
|---|----------------|-------------|
| <input type="checkbox"/> Headrest small 90 mm, multi-adjustable | 005.25.3020 | 545.00 |
| <input type="checkbox"/> with quick release handles for easy adjustment | 005.25.3020 kl | 680.00 |
| <input type="checkbox"/> Headrest large 130 mm, multi-adjustable | 005.25.3021 | 545.00 |
| <input type="checkbox"/> with quick release handles for easy adjustment | 005.25.3021 kl | 680.00 |
| <input type="checkbox"/> Abduction block, mounted with special fixture | 005.20.1206 | 185.00 |
| <input type="checkbox"/> Heel loops | 25.3011 | 60.00 |
| <input type="checkbox"/> Instep bands with quick-release buckles and upholstery | 30.4835 | 85.00 |
| <input type="checkbox"/> Heel shells with instep band | 25.3013 | 115.00 |
| <input type="checkbox"/> Calf strap (5cm) incl. fixture, with velcro closure | 003.20.1211 | 88.00 |
| <input type="checkbox"/> Seatbelt with easy snap buckle: | 25.3081 | 145.00 |
| <input type="checkbox"/> Glass table transparent, 600 x 450 mm (width x depth) to be swivelled out to the left or right; swivels out opposite to the control panel side | 001.20.1218 | auf Anfrage |

Distance between back and belly:

Indicate distance x!

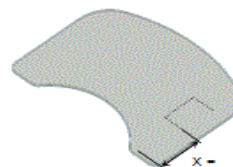

| | | | |
|---|--|---------------------|-------------|
| <input type="checkbox"/> Backbag SKS | | 65.3061 | 79.00 |
| <input type="checkbox"/> Bag below armrest SKS | | 65.3062 | 69.00 |
| <input type="checkbox"/> Transfer handles, indicate position | | 25.3057 | auf Anfrage |
| <input type="checkbox"/> Medical device platform, indicate measures | | 25.3065 | 650.00 |
| <input type="checkbox"/> Rearview mirror mounted on special swivel-down uni | <input type="checkbox"/> left <input type="checkbox"/> right | 001.20.1216/25.3004 | 265.00 |
| <input type="checkbox"/> Cane fixture (for 2 canes), mounted on the rear | <input type="checkbox"/> left <input type="checkbox"/> right | 001.20.1209 | 145.00 |
| <input type="checkbox"/> Snap-hook system for respirator system | | 005.20.1207 | 225.00 |

10 Shipment and delivery

| | | |
|---|-------------|--------|
| <input checked="" type="checkbox"/> Shipment, packaging und customs | Transk | |
| <input checked="" type="checkbox"/> Be aware of the fact that the VAT is to be added, yet incurred seperately by the customs authority. | MwSt Export | |
| <input type="checkbox"/> Delivery support by SKS-employee | 25.3054 | 495.00 |
| | 25.3054kl | 450.00 |
| <input checked="" type="checkbox"/> Prices are ex VAT and ex. works | | |

Sketch positions, details and specials
